

RAFIX 22 FS⁺, pushbutton, flat bezel, round collar, latching,
frontring metallic silver, bezel black



fields of application

› Measurement-control-regulation

› Electrical engineering

› Mechanical and system engineering

› Vehicle construction

› Handheld terminals

› Industrial robots

special features

› Pushbuttons with opaque bezels, not illuminable

› Low installation depth 9.2 mm (PCB) or 27 mm (QC)

› Special tactile feedback

› Ideal for operation with gloves

› Connection types: printed circuit board connection (PCB) or plug-in connection (QC)

› PCB switching elements minimize assembly errors

› Switching elements with silver contacts (max. 250 V/4 A) or gold contacts (max. 35 V/100 mA)

› Due to the tactile switch adapter MICON 5 tactile switches can be used as switching element

› Design adaptation by different front ring variations

› Degree of protection: IP 65 at the front

› Two collar shapes: round and square



description

RAFIX control devices are defined at RAFI as modular elements, consisting of an actuating element, if necessary a coupling and an individual contact or lighting unit.

Actuating elements (such as pushbuttons, emergency stop actuators, etc.) have the intended tactility, reset and function only when assembled with the appropriate switching elements.

Pushbuttons with opaque and therefore non-illuminable bezels.

technical data

› general		direct links
Disassembly possible	no	› RAFI eCatalog
Bezel color	black	
Property of bezel / mushroom	opaque	
Front ring color	metallic silver	

Collar shape	round
Operating temperature, min.	-25 °C
Operating temperature, max.	70 °C
Storage temperature, min.	-40 °C
Storage temperature, max.	80 °C
illuminated	No
Packaging	Box
Packaging unit	10 pcs.
net weight	6.4 g
Operating life	500,000 cycles
B10	650,000 cycles
Degree of protection, front side, according to DIN EN 60529	IP65
UL Enclosure Type Rating front side	type 1 type 4X indoor
Environment resistance	IEC 60068-2-14 IEC 60068-2-30 IEC 60068-2-33 IEC 60068-2-78
Salt-spray resistance according to standard	IEC 60068-2-11
MOQ order	10 pcs.
RoHS compliant	Yes
REACH compliant	Yes
> mounting diameters	
Outside dimension, length	29.8 mm
Outside dimension, width	29.8 mm
Outside dimension, height	18.5 mm
Mounting hole	22.3 mm
Mounting depth	9.2 mm
Installation height	9.85 mm
Grid, min.	30 x 30 mm
Collar dimension	ø 29,8 mm
> mechanical data	
Actuation function	latching
Operating force, max.	100 N
Operating travel, max.	4 mm
Fixing	Threaded ring
Threaded ring torque, max.	1.2 Nm

drawings

Dimensioned drawing

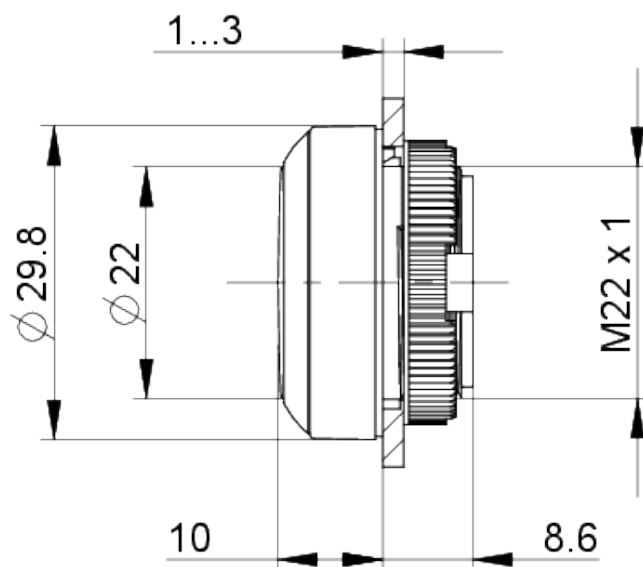

System drawing



System drawing



Mounting hole drawing



acc. to IEC 60947-5-1

front panel drawing

