

# E-BOX M12, emergency stop, 2 NC + 1 signaling contact, Gold, M12 8-pin A-coded, reset by rotating, Mushroom head red



## fields of application

- Measurement-control-regulation
- Mechanical and system engineering
- Construction machinery
- Industrial robots
- Model construction
- Home technology

## special features

- Compact dimensions: 109 x 40 x 27 mm
- Various actuator-indicator combinations from the RAFIX 22 FS+ control unit series
- With yellow upper part of housing for combinations with emergency stop actuator
- With gray upper part of housing for pushbutton combinations
- Mounting with time-saving single-hole screw mounting technology, particularly suitable for aluminum profile rails or alternatively direct mounting with M4 screws
- Connection with M12 plug: "Plug and Play"



## description

The E-Box M12 is a ready-to-connect, completely equipped housing including actuator and switching elements. Thus, for example, emergency stop, on/off and up/down functions, also with additional status displays, can be implemented with the very compact dimensions of the E-Box. The assembly: Screw on the clip, put on the box, connect the plug, check and ready. The E-Box M12 can be used wherever individual command device units are required at decentralized locations. Typically, for example, for emergency stop applications along a production facility or at the safety fence. The dimensions of the E-Box M12 are based on the edge dimensions of a 40 mm profile rail and the mounting concept is also designed for this.

## technical data

### ➤ general

Actuator position 1	Emergency stop
Color	yellow
Color of mushroom	red
Operating temperature, min.	-25 °C
Operating temperature, max.	70 °C
Storage temperature, min.	-40 °C
Storage temperature, max.	80 °C
illuminated	No
Packaging	Box
Packaging unit	1 pcs.
net weight	108 g
Operating life	50,000 cycles
B10	65,000 cycles

### direct links

- [RAFI eCatalog](#)

B10d	130,000 cycles
Degree of protection, front side, according to DIN EN 60529	IP65
Degree of protection, rear side, according to DIN EN 60529	IP65
Protection class	II
MOQ order	5 pcs.
RoHS compliant	Yes
REACH compliant	Yes
<b>&gt; mounting diameters</b>	
Outside dimension, length	123.2 mm
Outside dimension, width	40 mm
Outside dimension, height	60.2 mm
<b>&gt; mechanical data</b>	
Contact function	2 NC + 1 signaling contact
Contact material	Gold
Resetting	by rotating
Fixing	Assembly clip
Terminal on the rear	M12 8-pin A-coded
PIN 3	Normally open contact 1
PIN 4	Normally open contact 1
PIN 6	Normally closed contact 1
PIN 5	Normally closed contact 1
PIN 7	Normally closed contact 2
PIN 8	Normally closed contact 2
<b>&gt; electrical data</b>	
Rated voltage, min.	5 V
Rated voltage, max.	35 V
Voltage type	AC / DC
Rated operating voltage	5-35 V
Rated current, min.	0.001 A
Rated current, max.	0.1 A
Rated power, max.	0.25 W
Power loss	0.00030 W

## drawings

### Dimensioned drawing

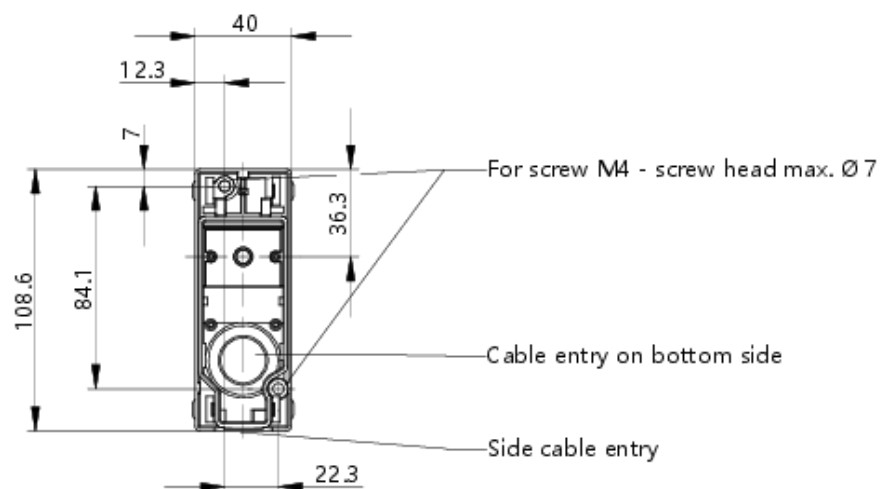

### System drawing

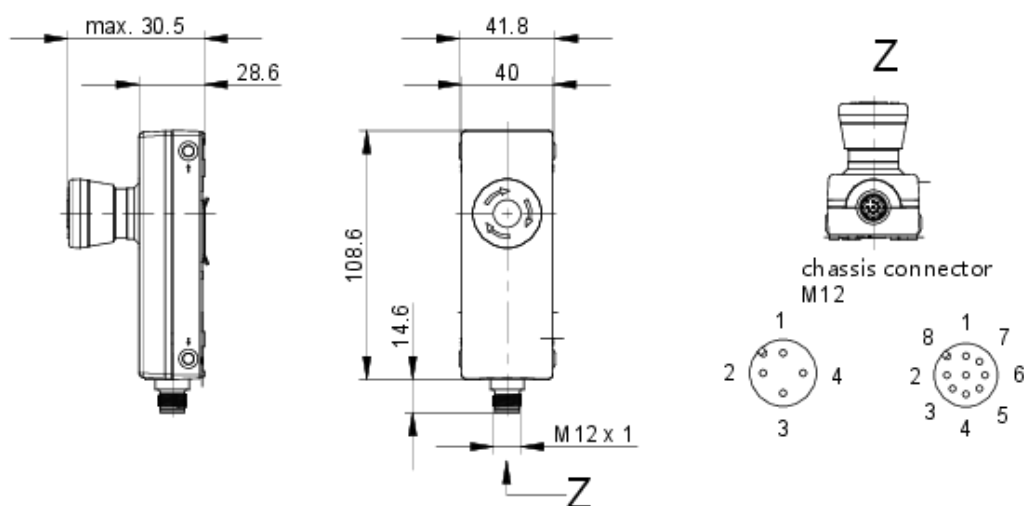

**Schematic diagram**