

# RAFIX 22 FS<sup>+</sup>, pushbutton, flat bezel, round collar, latching, frontring black, bezel black

DISCONTINUED



fields of application

- Measurement-control-regulation
- Electrical engineering
- Mechanical and system engineering
- Vehicle construction
- Handheld terminals
- Industrial robots

special features

- Pushbuttons with opaque bezels, not illuminable
- Low installation depth 9.2 mm (PCB) or 27 mm (QC)
- Special tactile feedback
- Ideal for operation with gloves
- Connection types: printed circuit board connection (PCB) or plug-in connection (QC)
- PCB switching elements minimize assembly errors
- Switching elements with silver contacts (max. 250 V/4 A) or gold contacts (max. 35 V/100 mA)
- Due to the tactile switch adapter MICON 5 tactile switches can be used as switching element
- Design adaptation by different front ring variations
- Degree of protection: IP 65 at the front
- Two collar shapes: round and square



## description

RAFIX control devices are defined at RAFI as modular elements, consisting of an actuating element, if necessary a coupling and an individual contact or lighting unit.

Actuating elements (such as pushbuttons, emergency stop actuators, etc.) have the intended tactility, reset and function only when assembled with the appropriate switching elements.

Pushbuttons with opaque and therefore non-illuminable bezels.

## technical data

➤ general

|                              |        |
|------------------------------|--------|
| Disassembly possible         | no     |
| Bezel color                  | black  |
| Property of bezel / mushroom | opaque |
| Front ring color             | black  |

direct links

- [RAFI eCatalog](#)

|  |  |
|--|--|
| Collar shape   | round  |
| Operating temperature, min.                                    | -25 °C   |
| Operating temperature, max.                                    | 70 °C  |
| Storage temperature, min.                                      | -40 °C   |
| Storage temperature, max.                                      | 80 °C  |
| illuminated  | No   |
| Packaging  | Box  |
| Packaging unit   | 10 pcs.  |
| Operating life   | 500,000 cycles   |
| B10  | 650,000 cycles   |
| Degree of protection, front side,<br>according to DIN EN 60529 | IP65   |
| UL Enclosure Type Rating front<br>side                         | type 1<br>type 4X indoor   |
| Environment resistance   | IEC 60068-2-14<br>IEC 60068-2-30<br>IEC 60068-2-33<br>IEC 60068-2-78 |
| Salt-spray resistance according to<br>standard                 | IEC 60068-2-11   |
| MOQ order  | 100 pcs.   |
| RoHS compliant   | Yes  |
| REACH compliant  | Yes  |
| <b>&gt; mounting diameters</b>                                 |  |
| Outside dimension, length                                      | 29.8 mm  |
| Outside dimension, width                                       | 29.8 mm  |
| Outside dimension, height                                      | 18.5 mm  |
| Mounting hole  | 22.3 mm  |
| Mounting depth   | 9.2 mm   |
| Installation height  | 9.85 mm  |
| Grid, min.   | 30 x 30 mm   |
| Collar dimension   | ø 29,8 mm  |
| <b>&gt; mechanical data</b>                                    |  |
| Actuation function   | latching   |
| Operating force, max.  | 100 N  |
| Operating travel, max.   | 4 mm   |
| Fixing   | Threaded ring  |
| Threaded ring torque, max.                                     | 1.2 Nm   |

## drawings

### Dimensioned drawing

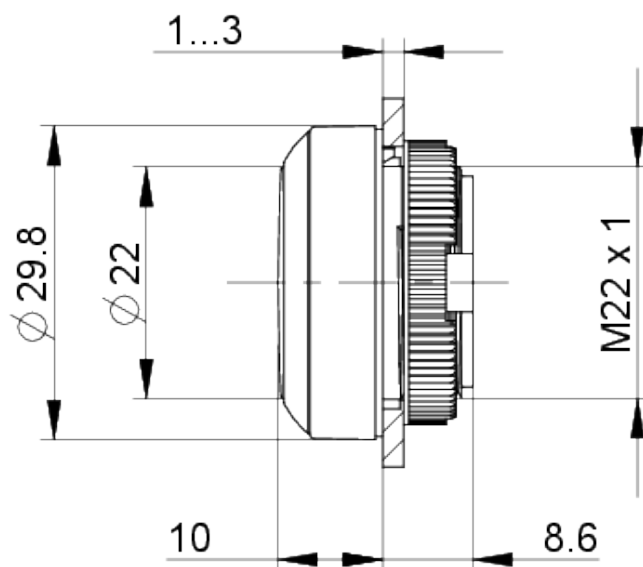

### System drawing



## System drawing



## Mounting hole drawing



acc. to IEC 60947-5-1

## front panel drawing

